

Terms and Conditions for allotment of Built up space in the Standard Design Factory Building(SDF) at KSIDC Investment Zone Palakkad.

1. The allotment of built up space will commence only after 5.09.2016.
2. The total area of the SDF is 60000 sqft in 3 floors.
3. The size of individual module ranges from 1250 sqft to 2000 sqft
4. Heavy machineries will be permitted only on Ground floor of the SDF.
5. The design strength of 1st and 2nd floor of the SDF building is to carry a Live Load of 5KN/m2.
6. Presently the monthly rental of the SDF is Rs.11 per sqft + ST. 10% increment will be applicable in the subsequent years. The proposed rent structure shall be for six years in a single agreement. Rent shall be subject to revision from time to time on prospective basis.
7. The allottee shall pay the proportionate rent for common areas and also pay the common service charges.
8. Security deposit equivalent to 12 months' rent shall be collected initially.
9. The applicant shall download the application for allotment from the website www.ksidc.org from the link **Industrial Growth Centre**.
10. A Detailed Project Report along with an application fee of Rs.10000 +ST shall be submitted together with the application for allotment.
11. The allotment shall be on first come first serve basis depending on the evaluation of the proposal by the Committee constituted by KSIDC for allotment of land and built up space in Industrial Parks.
12. Applicant shall show preferred area in the sketch with three options.

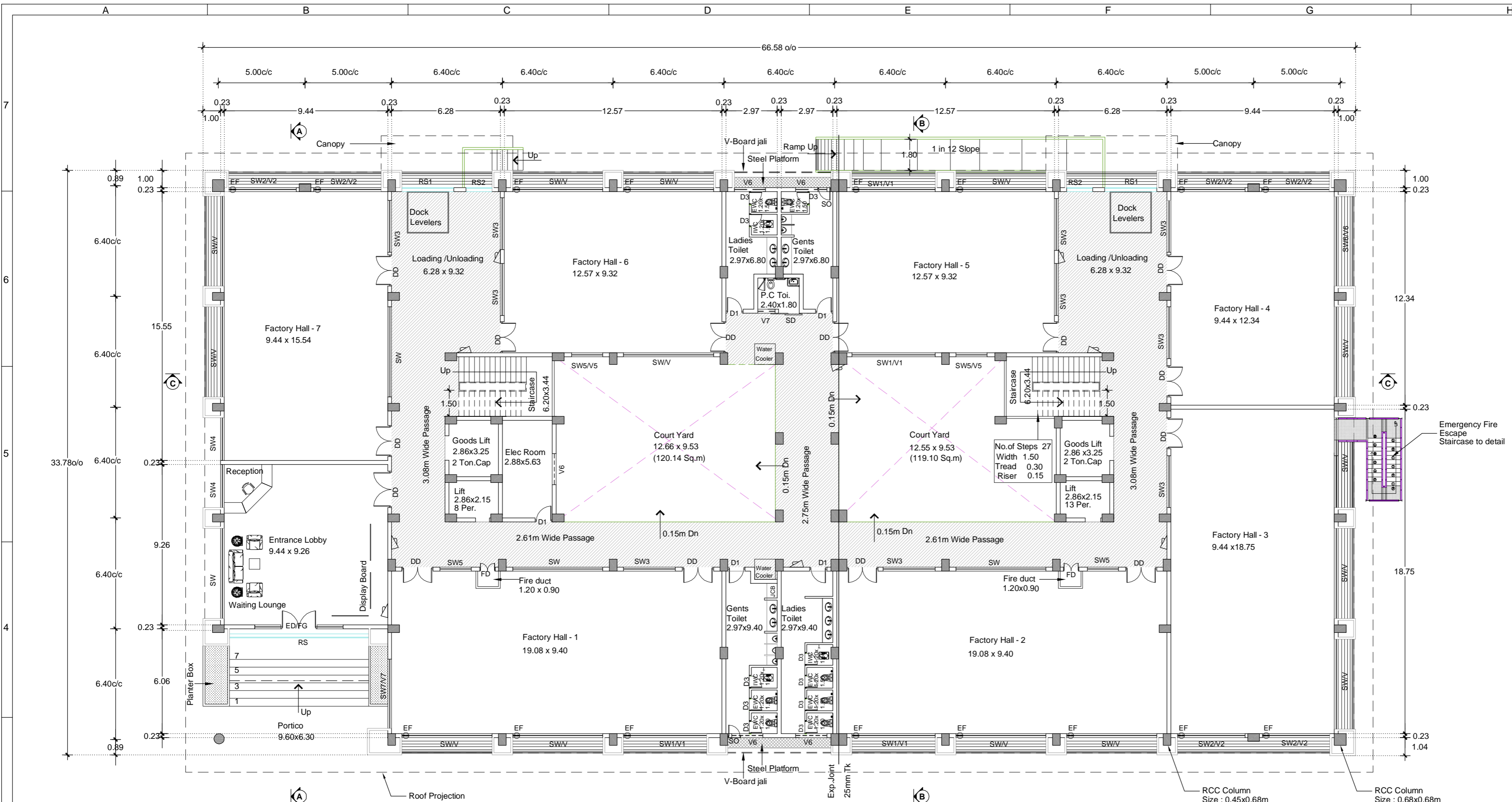

Ground Floor Plan
Scale - 1:100

Schedule of Joinery :

S.No.	Type	Description	Size
1.	RS	Rolling Shutter	8.035 x 3.00
2.	RS1	Rolling Shutter	3.00 x 3.00
3.	RS2	Rolling Shutter	1.50 x 3.00
4.	ED/FG	Entrance Door	2.10/1.50 x 2.40
5.	DD	Double Door	1.80 x 2.40
6.	D1	Door	1.00 x 2.10
7.	D3	Door	0.75 x 2.10
8.	SD	Sliding Door	1.20 x 2.10
9.	FD	Fire Door	0.90 x 2.10
10.	SW/V	Sliding Window/Ventilator	5.20 x 1.40/1.10
11.	SW1/V1	Sliding Window/Ventilator	4.80 x 1.40/1.10
12.	SW2/V2	Sliding Window/Ventilator	3.90 x 1.40/1.10
13.	SW3	Sliding Window	3.00 x 1.40
14.	SW4/V4	Sliding Window/Ventilator	2.485 x 1.40/1.10
15.	SW5/V5	Sliding Window/Ventilator	1.80 x 1.40/1.10
16.	SW6/V6	Sliding Window/Ventilator	5.16 x 1.40/1.10
17.	V6	Ventilator	1.80 x 1.50
18.	V7	Ventilator	1.00 x 0.60
19.	SO	Service Opening	0.75 x 1.50
20.	EF	Exhaust Fan	0.36m Ø

Area Statement :

S.No	Category	Area(Sq.m)	Area(Sq.f)
1	Ground Floor Plan	1,800.00	19375.04
2	First Floor Plan	1,769.00	19041.36
3	Second Floor Plan	1,482.00	15952.10
Total Area		5,051.00	54368.50

Key Plan:

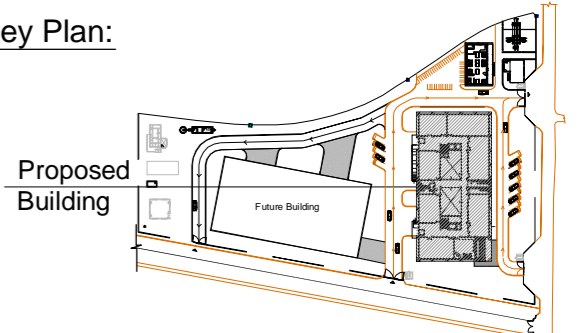

Notes :

Sl.No	Name of Room	Area in Sq.m (C/C)
Ground Floor		
1	Entrance Lobby	95.04
2	Factory Hall - 7	155.40
3	Factory Hall - 1	191.43
4	Gents Toilet (Near to Factory Hall 2)	31.63
5	Ladies Toilet	31.39
6	Factory Hall - 2	190.32
7	Factory Hall - 3	186.70
8	Factory Hall - 4	124.11
9	Loading / Unloading Area - 1	62.90
10	Factory Hall - 5	123.72
11	Gents Toilet (Near to Factory Hall 5)	21.88
12	Ladies Toilet	20.30
13	PC Toilet	5.64
14	Factory Hall - 6	123.71
15	Loading / Unloading Area - 2	62.28
17	Passage Area	291.67
18	Goods Lift 1	11.52
19	Lift (8 Per)	8.01
20	Elec Room	19.66
21	Lift (13 Per)	8.30
22	Goods Lift 2	11.94
23	Staircase - 1	11.23
24	Staircase - 2	11.23
Ground Floor Area		1800.00

REV.NO.	DATE	DESCRIPTION

Client:



KERALA STATE INDUSTRIAL DEVELOPMENT CORPORATION

Consultants:

Mukesh & Associates
consultants & engineers
www.mukeshassociates.com
2/6, Ranganathar Avenue,
Perumal malai road (via)
Narasothipatti, Salem - 636 004
TEL : (0427) 2330567, 2331219
FAX : 2330565
INDIA
e-mail : dhislam@rediffmail.com

LIGHT ENGINEERING INDUSTRIAL PARK AT PALAKKAD

Title:

Ground Floor Plan

CONCEPT TENDER GOOD FOR CONSTRUCTION

Proj No:	Drawing No:	Sheet:	Rev:
03.11.2014	KSIDC-SDF- PAL-MAB-AR-1002	A2	00
Date:	File name :	Plot scale:	Drawn:
03.11.2014		A.V.P	Chkd.: C.R

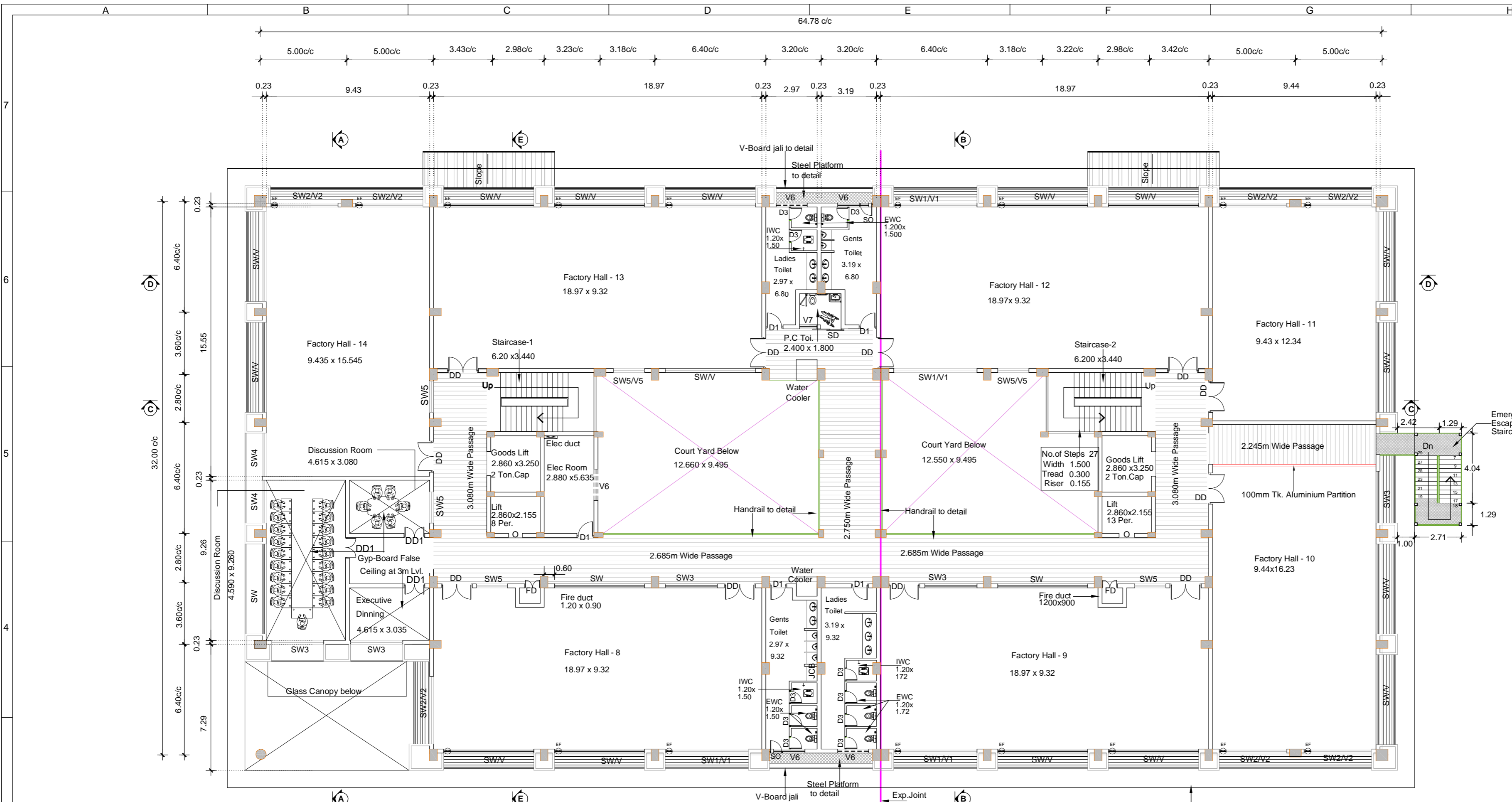

First Floor Plan
Scale - 1:100

Schedule of Joinery :

S.No.	Type	Description	Size
1.	RS	Rolling Shutter	8.035 x 3.00
2.	RS1	Rolling Shutter	3.00 x 3.00
3.	RS2	Rolling Shutter	1.50 x 3.00
4.	ED/FG	Entrance Door	2.10/1.50 x 2.40
5.	DD	Double Door	1.80 x 2.40
6.	D1	Door	1.00 x 2.10
7.	D3	Door	0.75 x 2.10
8.	SD	Sliding Door	1.20 x 2.10
9.	FD	Fire Door	0.90 x 2.10
10.	SW/V	Sliding Window/Ventilator	5.20 x 1.40/1.10
11.	SW1/V1	Sliding Window/Ventilator	4.80 x 1.40/1.10
12.	SW2/V2	Sliding Window/Ventilator	3.90 x 1.40/1.10
13.	SW3	Sliding Window	3.00 x 1.40
14.	SW4/V4	Sliding Window/Ventilator	2.485 x 1.40/1.10
15.	SW5/V5	Sliding Window/Ventilator	1.80 x 1.40/1.10
16.	SW6/V6	Sliding Window/Ventilator	5.16 x 1.40/1.10
17.	V6	Ventilator	1.80 x 1.50
18.	V7	Ventilator	1.00 x 0.60
19.	SO	Service Opening	0.75 x 1.50
20.	EF	Exhaust Fan	0.36m Ø

Area Statement :

S.No	Category	Area(Sq.m)	Area(Sq.f)
1	Ground Floor Plan	1,800.00	19375.04
2	First Floor Plan	1,769.00	19041.36
3	Second Floor Plan	1,482.00	15952.10
Total Area		5,051.00	54368.50

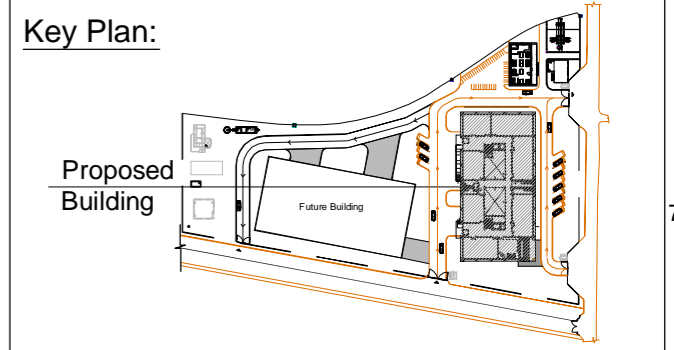

Notes :

Sl.No	Name of Room	Area in Sq.m (C/C)
First Floor		
1	Factory Hall - 1	188.95
2	Gents Toilet (Near to Factory Hall 2)	31.30
3	Ladies Toilet	33.45
4	Factory Hall - 2	187.75
5	Factory Hall - 3	163.23
6	Factory Hall - 4	125.23
7	Factory Hall - 5	185.57
8	Gents Toilet (Near to Factory Hall 5)	21.88
9	Ladies Toilet	20.54
10	PC Toilet	5.64
11	Factory Hall - 6	185.57
12	Factory Hall - 7	155.40
13	Discussion Room 1	16.42
14	Discussion Room 2	47.40
15	Executive Dining	15.99
16	Anti Space	14.46
17	Passage Area	288.34
18	Goods Lift 1	11.52
19	Lift (8 Per)	8.01
20	Elec Room	19.66
21	Lift (13 Per)	8.30
22	Goods Lift 2	11.94
23	Staircase - 1	11.23
24	Staircase - 2	11.23
First Floor Area		1769.00

REV.NO.	DATE	DESCRIPTION

Client:



KSIDC
KERALA STATE INDUSTRIAL DEVELOPMENT CORPORATION

Consultants:



Mukesh & Associates
consultants & engineers
www.mukeshassociates.com
2/6, Ranganathar Avenue,
Perumal malai road (via)
Narasothipatti, Salem - 636 004
TEL : (0427) 2330567, 2331219
FAX : 2330565
INDIA
e-mail : dhislam@rediffmail.com

LIGHT ENGINEERING INDUSTRIAL PARK AT PALAKKAD

Title:
First Floor Plan

<input type="checkbox"/> CONCEPT	<input type="checkbox"/> TENDER	<input checked="" type="checkbox"/> GOOD FOR CONSTRUCTION
Proj No: KSIDC-SDF- PAL-MAB-AR-1002	Drawing No: A2	Sheet: 00
Date: 03.11.2014	File name: A.V.P	Plot scale: A.V.P
	Drawn: A.V.P	Chkd.: C.R

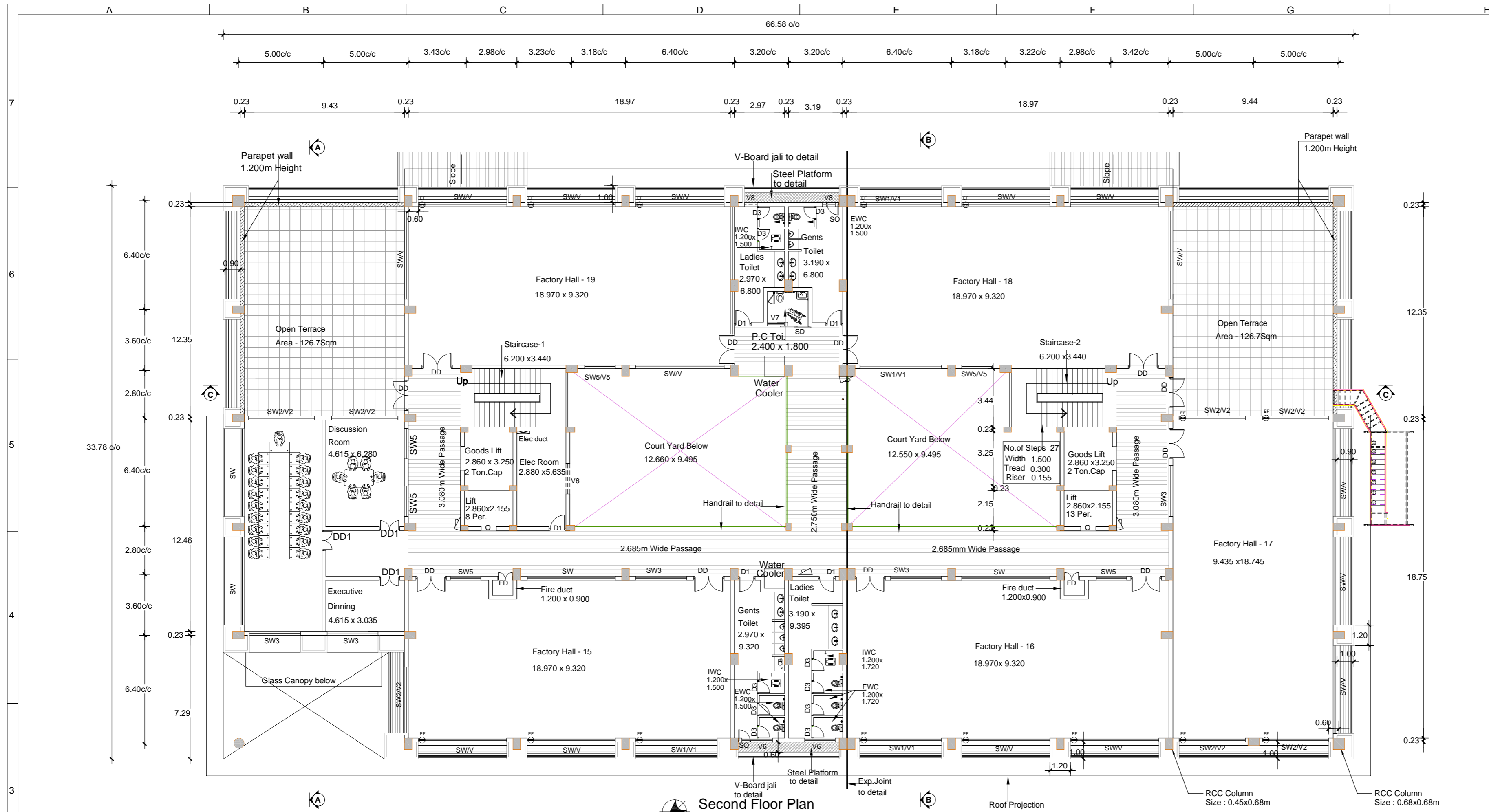

Second Floor Plan

Schedule of Joinery :

S.No.	Type	Description	Scale - Size
1.	RS	Rolling Shutter	8.035 x 3.00
2.	RS1	Rolling Shutter	3.00 x 3.00
3.	RS2	Rolling Shutter	1.50 x 3.00
4.	ED/FG	Entrance Door	2.10/1.50 x 2.40
5.	DD	Double Door	1.80 x 2.40
6.	D1	Door	1.00 x 2.10
7.	D3	Door	0.75 x 2.10
8.	SD	Sliding Door	1.20 x 2.10
9.	FD	Fire Door	0.90 x 2.10
10.	SW/V	Sliding Window/Ventilator	5.20 x 1.40/1.10
11.	SW1/V1	Sliding Window/Ventilator	4.80 x 1.40/1.10
12.	SW2/V2	Sliding Window/Ventilator	3.90 x 1.40/1.10
13.	SW3	Sliding Window	3.00 x 1.40
14.	SW4/V4	Sliding Window/Ventilator	2.485 x 1.40/1.10
15.	SW5/V5	Sliding Window/Ventilator	1.80 x 1.40/1.10
16.	SW6/V6	Sliding Window/Ventilator	5.16 x 1.40/1.10
17.	V6	Ventilator	1.80 x 1.50
18.	V7	Ventilator	1.00 x 0.60
19.	SO	Service Opening	0.75 x 1.50
20.	EF	Exhaust Fan	0.36m Ø

Area Statement :

S.No	Category	Area(Sq.m)	Area(Sq.f)
1	Ground Floor Plan	1,800.00	19375.04
2	First Floor Plan	1,769.00	19041.36
3	Second Floor Plan	1,482.00	15952.10
Total Area		5,051.00	54368.50

Key Plan:

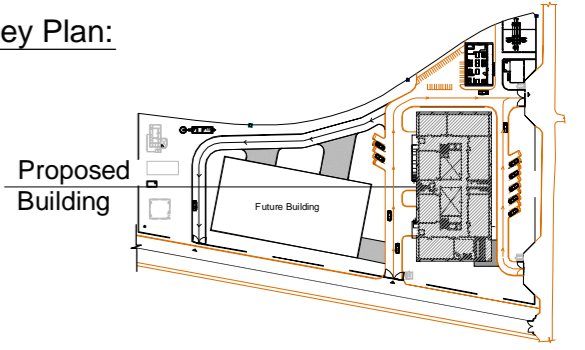

Notes :

Sl.No	Name of Room	Area in Sq.m (C/C)
Second Floor		
1	Factory Hall - 15	188.95
2	Gents Toilet	31.30
3	Ladies Toilet	33.45
4	Factory Hall - 16	187.75
5	Factory Hall - 17	187.82
6	Factory Hall - 18	186.68
7	Gents Toilet	21.88
8	Ladies Toilet	20.54
9	PC Toilet	5.64
10	Factory Hall - 19	186.68
11	Discussion Room 1	32.86
12	Executive Dining	15.99
13	Anti Space	14.46
14	Discussion Room 2	63.76
15	Passage Area	222.36
16	Goods Lift 1	11.52
17	Lift (8 Per)	8.01
18	Elec Room	19.66
19	Lift (13 Per)	8.30
20	Goods Lift 2	11.94
21	Staircase - 1	11.23
22	Staircase - 2	11.23
Second Floor Area		1482.00

REV.NO.	DATE	DESCRIPTION

Client:



KERALA STATE INDUSTRIAL DEVELOPMENT CORPORATION

Consultants:

Mukesh & Associates
 consultants & engineers
 www.mukeshassociates.com
 2/6, Ranganathar Avenue,
 Perumal malai road (via)
 Narasothipatti, Salem - 636 004
 TEL : (0427) 2330567, 2331219
 FAX : 2330565
 INDIA
 e-mail : dhism@rediffmail.com

LIGHT ENGINEERING INDUSTRIAL PARK AT PALAKKAD

Title:

Second Floor Plan

CONCEPT TENDER GOOD FOR CONSTRUCTION

Proj No:	Drawing No:	Sheet:	Rev:
03.11.2014	KSIDC-SDF- PAL-MAB-AR-1002	A2	00
Date:	File name :	Plot scale:	Drawn:
		A.V.P	
		Chkd.:	
		C.R	